



San Ysidro Land Port of Entry Expansion & Reconfiguration

Smart Border Coalition

U.S. General Services Administration

*September 5, 2019
San Diego, CA*



San Ysidro LPOE Phase 2

Ped East Building

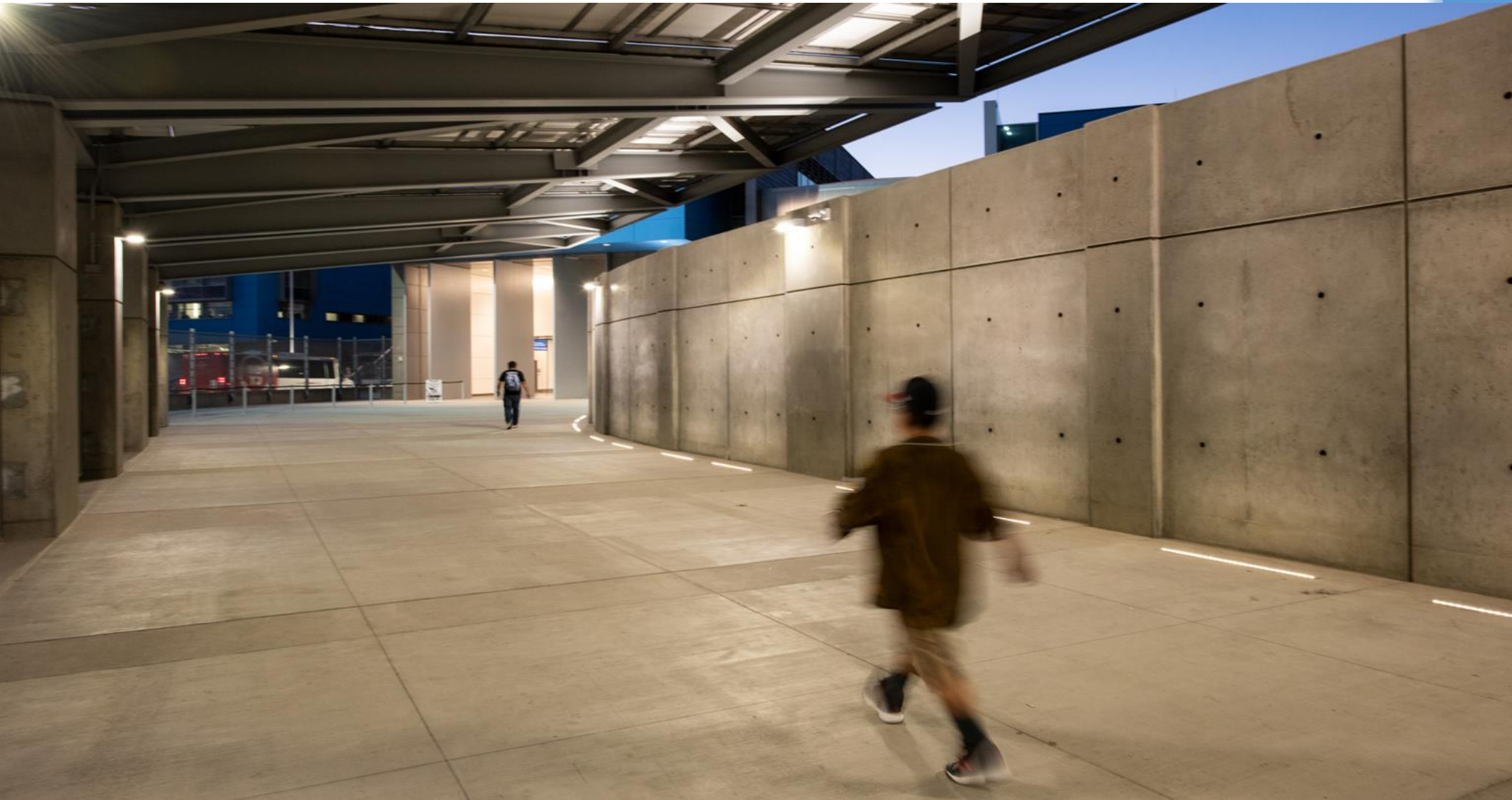



San Ysidro LPOE Phase 2 Ped East Building

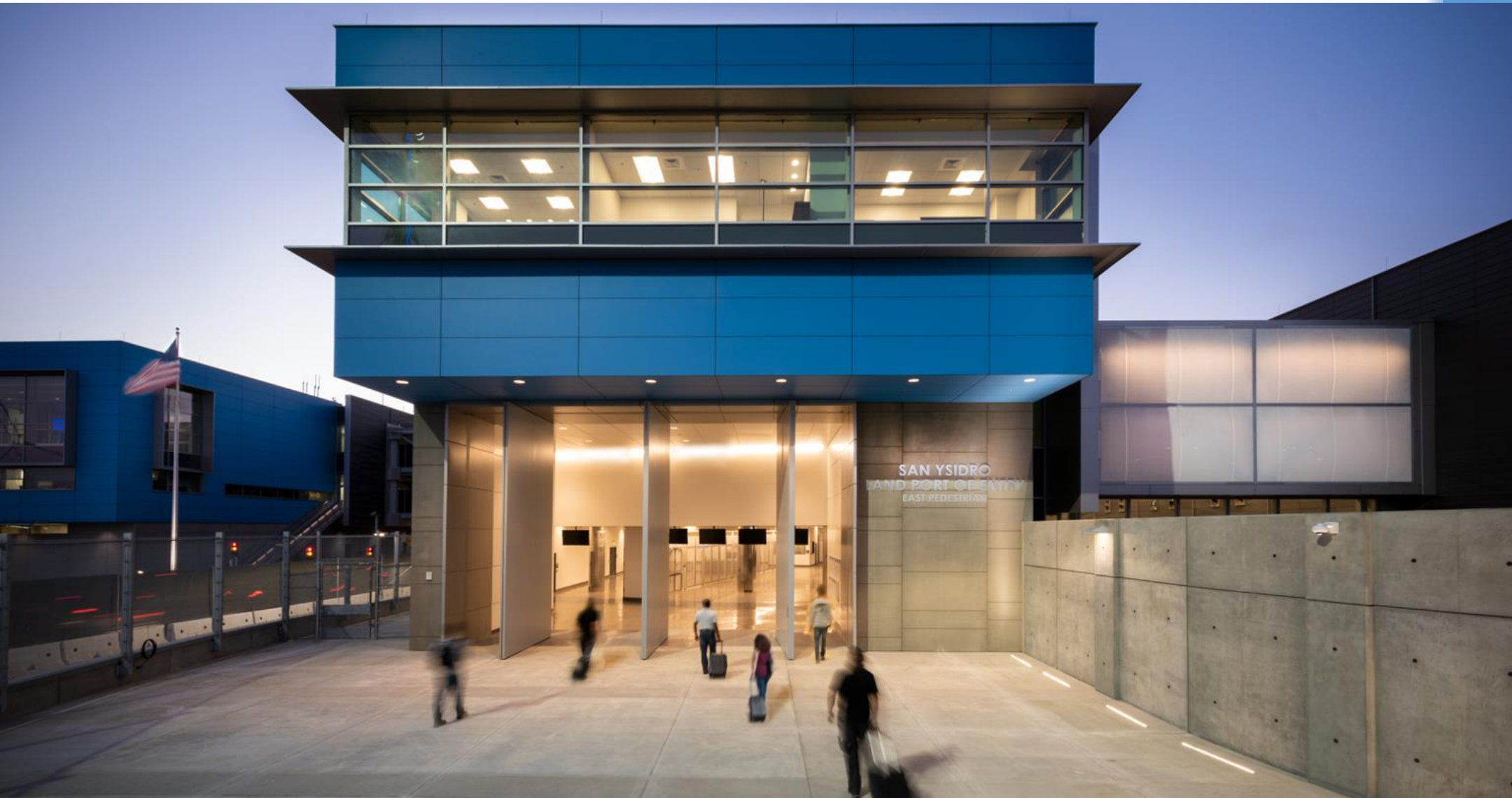



San Ysidro LPOE Phase 2

Ped East Building





San Ysidro LPOE Phase 2 Ped East Building





San Ysidro LPOE Phase 2

Pedestrian Plaza





San Ysidro LPOE Phase 2

Historic Customs House





San Ysidro LPOE Phase 2

Historic Customs House





San Ysidro LPOE Phase 2

Historic Customs House





San Ysidro LPOE Phase 3 (2019)

- Realignment of the I-5 South freeway (10 new southbound lanes and primary inspection booths)
- CBP southbound headhouse and secondary inspection canopy
- Employee parking structure
- Adds 8 new northbound inspection lanes and 15 new booths





San Ysidro LPOE Phase 3

Aerial View





San Ysidro LPOE Phase 3





San Ysidro LPOE Phase 3





San Ysidro LPOE Phase 3





Otay Mesa LPOE

U.S. General Services Administration

*July 9, 2018
Tijuana, Mexico*

Project Scope Diagram

4.0 Programming
4.1 Program - Objectives Diagram

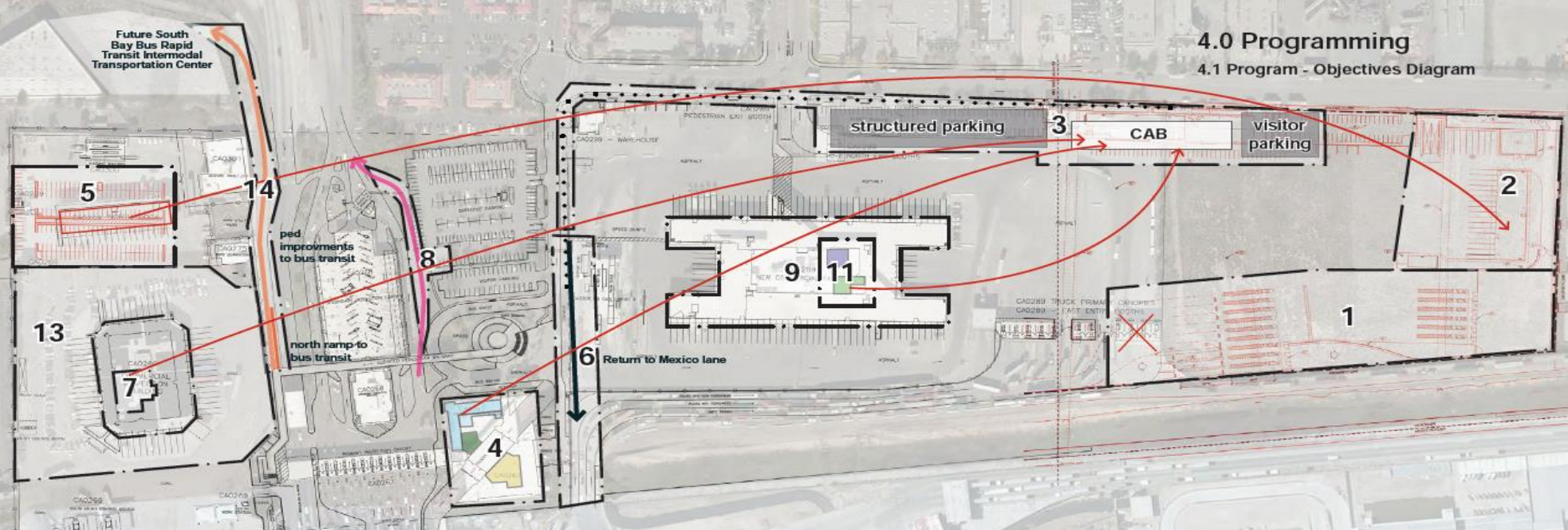

Objectives

1. New commercial import primary and exit booths
2. Relocation of commercial import hazmat to the import lot
3. New Commercial Annex Building to house FDA, TTEC (SENTRI, FAST and Global Entry) CBP, and I-94 Processing
4. Relocate SENTRI and I-94 Processing from the existing pedestrian building to the new CAB and backfill the space in the Main Building with additional inbound pedestrian booths and detention
5. Commercial Export surface parking
6. Dedicated return to Mexico Lane
7. Expand CAB program to relocate Fines, Penalties, and Forfeitures (FP&F) paralegal staff from Commercial Export Building and backfill vacated space with CBP Regional Training Center
8. Federal Motor Carrier Safety Administration (FMCSA) Building and bus inspection lanes and canopy.
9. Existing Commercial Import Building interiors refresh
10. Correction of deficiencies in existing buildings related to building systems, security, and other LPOE Design Guide requirements.
11. Backfill areas vacated by FDA and USDA in Commercial Import Building
12. Energy and water-efficiency improvements to existing buildings, including stretch goals for sustainable building performance
13. Replace existing asphalt pavement in the commercial export lot with concrete pavement to be in conformance with current LPOE Design Guide requirements.
14. Pedestrian Access Improvements from the Otay Mesa LPOE to the South Bay Bus Rapid Transit ITC

*Areas shown in red taken from 2010 Modernization Plan

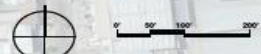



Planned Otoy Mesa Schedule

Funding Authorization	Q3/4	FY2018
Design-Build Solicitation	Q2	FY2019
Award Design-Build	Q4	FY2019
Construction completion	Q2	FY2022

QUESTIONS

Ramón D. Riesgo

U.S. General Services Administration

333 West Broadway, Suite 1001

San Diego, CA 92101-8843

Tel.: 619.557.5092

Fax: 619.557.7335

ramon.riesgo@gsa.gov

www.gsa.gov



Questions?

